

SK C74 Blackout Units

SK Blackout Blinds



SK C74 Crank Blackout

Features:

The SK C74 crank control blackout unit features a heavy duty 1:5 gear mechanism operated by a magnetic detachable crank handle. As standard, all hardware is available in Black/White powder-coated aluminium, with moulded Black/White plastic fittings, for face or recess fixing and encloses 53mm grooved aluminium barrel. Heavy-duty gear mechanism at right, controlled by fixed crank handle. Blackout fabric, with heavy-duty bottom bar, is locked into a groove in the barrel and runs in 75mm side channels. Slim bottom channel makes for positive attachment to side channels. Light-transfer baffles within side and bottom channels, and side channels and head-box fitted with pile-seal light sealing.

Benefits:

The SK C74 is the blackout unit of choice for many contract applications. Offering 100% blackout properties, it is simple to operate and very strong, covering large windows with ease. It is in use in many schools and hospitals where dependability is an essential requirement, but its sleek good looks are at home wherever high performance light exclusion is called for.

Options:

No bottom channel, with bottom bar running down to sill; Fixed crank handle; Available in any RAL colour.

Specification:

The SK C74 crank control 100% blackout unit with magnetic detachable crank handle. Flame retardant blackout fabric from the SK range, locked into grooved 53mm aluminium barrel along with aluminium bottom rail as standard. Heavy duty 1:5 geared crank mechanism is housed within black/white powder-coated aluminium head-box cassette, side and bottom channels and bottom bar supported by sturdy brackets.

Blackout Unit Profile Dimension Guide

| Model | Cassette Size (HxD) | Barrel Size Ø | Side Channel Size (WxD) | Side cheek |
|--------|---------------------|---------------|-------------------------|------------|
| SK C74 | 100 x 100mm | 53mm | 75 x 20mm | Metal |

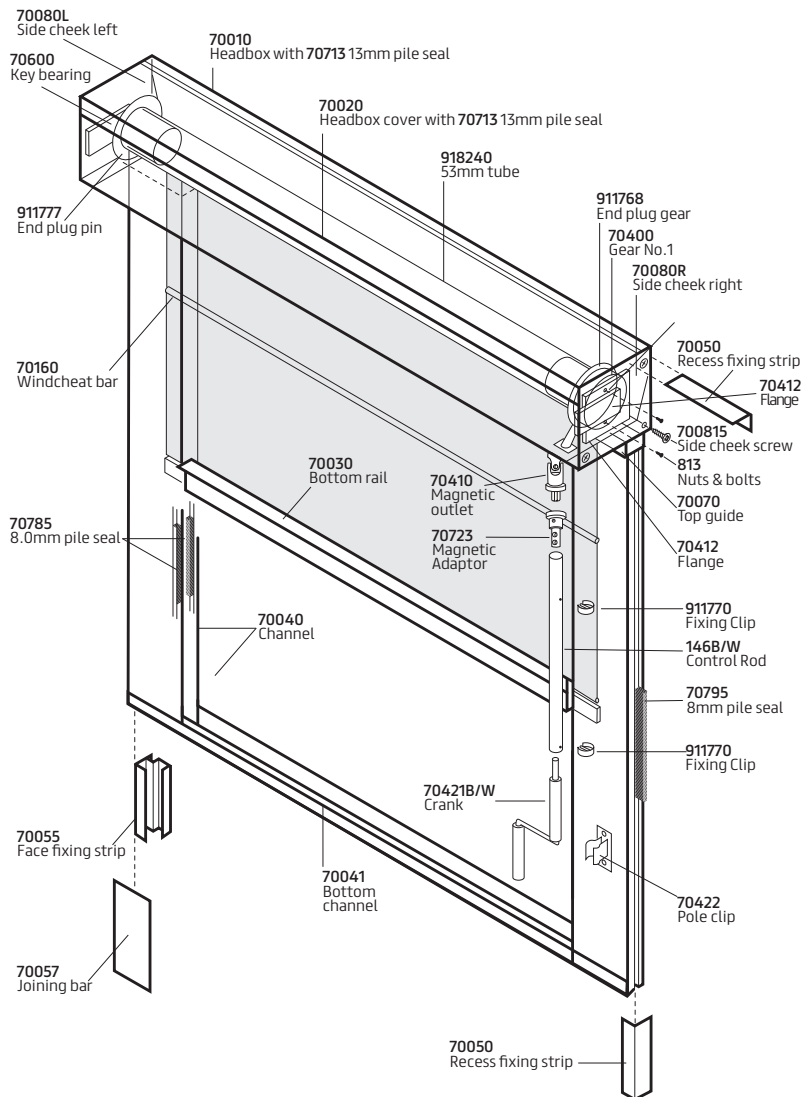

This product range comes with a full Lifetime Warranty as standard.