

SKF40/F40D Single/Double Door

SK Insect Screens



Insect Screen Specification Guide

Model	Min Width	Max Width	Min Drop	Max Drop	Max M ²
SK F40	400	1200	1000	2500	3.0
SK F40D	800	2500	1000	2500	6.0

Model	Cassette Size (HxD)	Keep Plate Size	Bottom Channel Size (WxD)	Top Channel Size (WxD)
SK F40	43 x 50mm	29 x 14mm	22 x 22mm	42 x 22mm
SK F40D	43 x 50mm	N/A	22 x 22mm	42 x 22mm

SK F40 Single Door SK F40D Double Door

Features:

The SK F40 horizontally retractable insect screen with advanced slow-rise spring control ensures smooth and quiet operation. Available as single door unit (F40) or double door unit (F40D) as applicable. White metal universal brackets for secure top fixing with powder-coated extruded aluminium cassette and side guide channels. Rot-proof PVC coated fibreglass mesh is locked into the barrel and bottom bar profile.

Benefits:

The slim, unobtrusive profile of the SK F40 roll-up system provides a suitable solution for doorways and large window openings in areas where food preparation is carried out. The 43mm cassette units will complement the décor of many interiors and the advanced spring operation ensures a reliable, consistency of use.

Specification:

The SK F40/F40D horizontally retractable single/double insect screen unit with advanced slow-rise spring operation. Vandal resistant spring and decelerator mechanism is housed within white powder-coated aluminium cassette. Roll-up flame retardant, rot-proof PVC coated fibreglass mesh held securely inside guide channels and bottom bar. Supported by sturdy metal brackets.

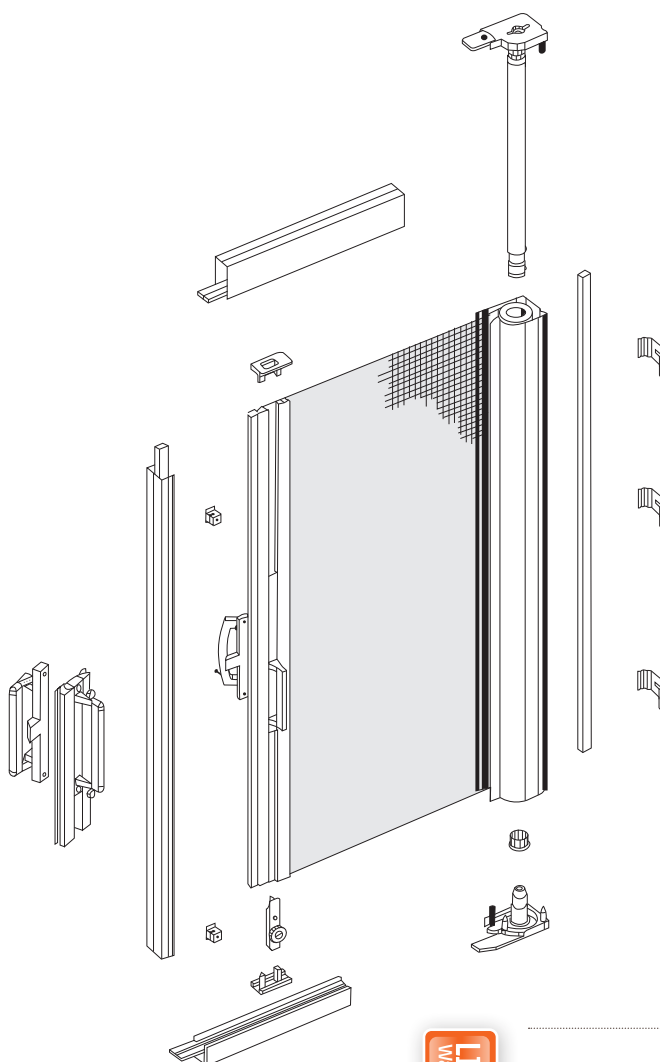

This product range comes with a full Lifetime Warranty as standard.