

# SK C27 Electric 230v

SK Cassetted Blinds

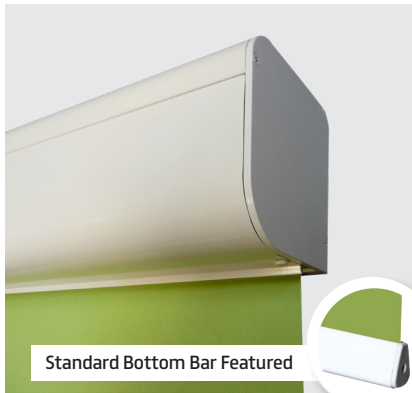

sol  
komfort  
interiors



Standard Bottom Bar Featured

## SK C27 Electric 230v

### Features:

The SK C27 electric cassetted blind features a 230v AC motor as standard. Cassette is designed for top or face fixing and accommodates 40mm grooved aluminium barrel, housing the motor. The motor is controlled by a switch which may be surface or flush mounted (not supplied as standard). Fabric is locked into groove in barrel and an aluminium bottom bar and an aluminium bottom bar. Black or white hardware as standard.

### Benefits:

The SK C27 offers a premium electric operated cassetted blind for situations where durability and functionality are required. Its quiet and reliable motor is housed within the barrel and further protected by the robust aluminium head-box housing. The fabric is locked into the barrel and bottom bar and will give years of trouble-free use. It is located in the groove so that it may be slid out sideways for easy repair or replacement of blind cover.

### Options:

Black or white hardware; Remote and/or group control systems in place of single switch; With side channels C47-90/120; Wire side-guiding system; Available in any RAL colour.

### Specification:

SK C27-90/120 electric cassetted blind. Flame retardant fabric from the SK range, locked into grooved 53/70mm aluminium barrel along with aluminium bottom bar as standard. 230v AC motor is housed within black/white aluminium cassette.

## Cassetted Blind Profile Dimension Guide

Model	Cassette Size (HxD)	Barrel Size Ø	Side Channel Size (WxD)
SK C27-90	105 x 95mm	53mm	n/a
SK C27-120	140 x 120mm	53 / 70mm	n/a

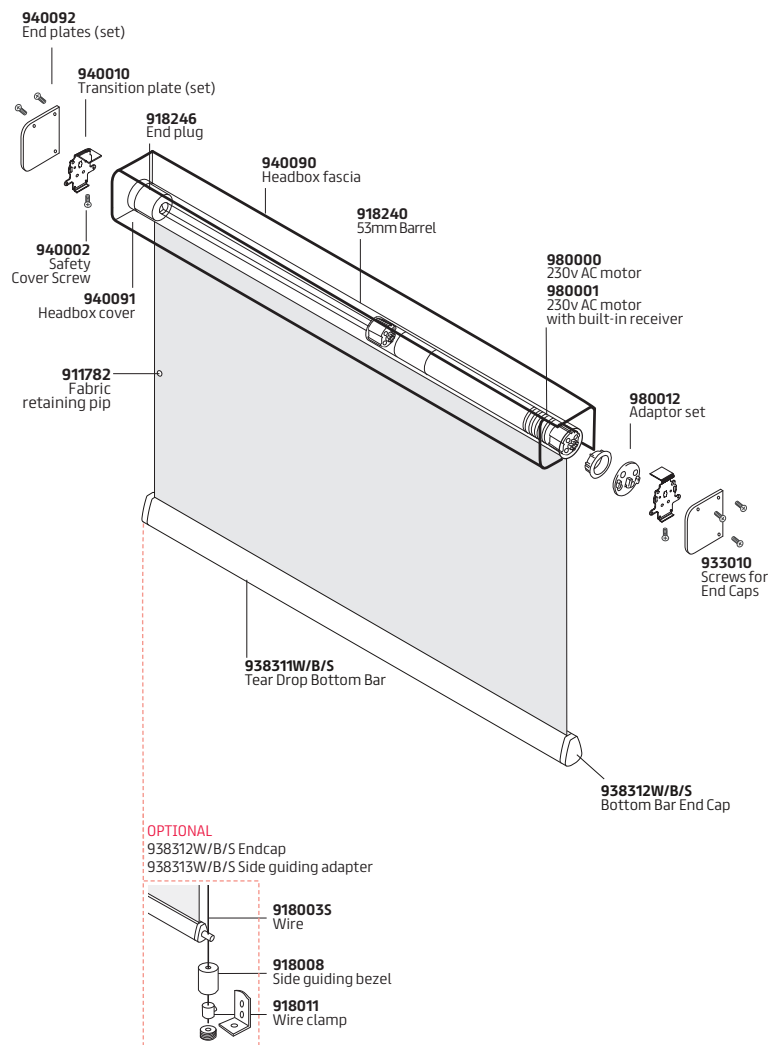

Find this product on NBS Source



This product range comes with a full Lifetime Warranty as standard.