

# SKC25 Electric 24v

SK Cassetted Blinds

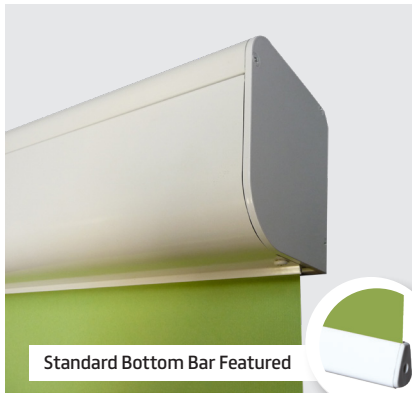

sol  
komfort  
interiors



Standard Bottom Bar Featured

## SK C25 Electric 24v

### Features:

The SKC25 electric cassetted blind features a low voltage 24v DC motor as standard. Cassette is designed for top or face fixing and accommodates a 40mm grooved aluminium barrel, housing the 24v DC motor. The motor is controlled by a switch which may be surface or flush mounted (not supplied as standard). Fabric is locked into a groove in the barrel and an aluminium bottom bar. Black or white hardware as standard.

### Benefits:

Fingertip control and a slim yet sturdy aluminium frame help this blind to lend an air of luxury to any environment and makes the C25 a perfect choice for motorised requirements. Its quiet and reliable motor is housed within the barrel and supported by sturdy, metal brackets.

### Options:

Black or white hardware; Remote and/or group control systems in place of single switch; With side channels C45-60/90. Wire side-guiding system; Available in any RAL colour.

### Specification:

SKC25-60/90 low voltage electric cassetted blind. Flame retardant fabric from the SK range, locked into grooved 40mm aluminium barrel along with aluminium bottom bar as standard. Low voltage 24v DC motor is housed within black/white aluminium cassette.

## Cassetted Blind Profile Dimension Guide

Model	Cassette Size (HxD)	Barrel Size Ø	Side Channel Size (WxD)
SK C25-60	77 x 73mm	40mm	n/a
SK C25-90	105 x 95mm	40mm	n/a

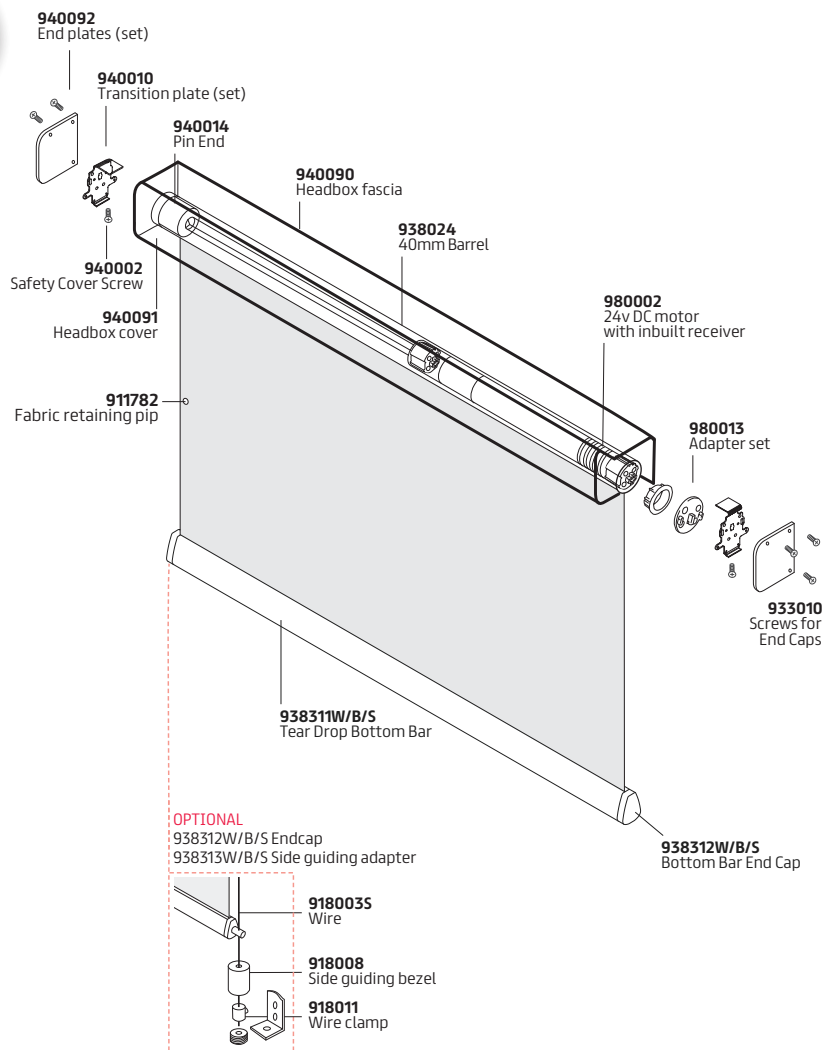

Find this product  
on NBS Source



This product range  
comes with a full  
Lifetime Warranty  
as standard.